

Variant with simmerring in front cover

Designation: 20A(C)...X188AS

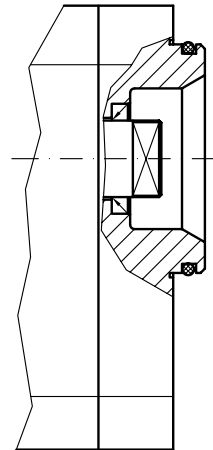

Type	Displacement cm ³ /rev	Flow		Pressure P _{nom} bar	max Speed n rpm	Dimension								
		at 1500 rpm l/min	at max rpm l/min			A mm	B mm	Inlet			Outlet			
						E	F	d	E	F	d			
20A(C)4,5X072	4,5	6,14	14,33	250	3500	37,3	75,1	40	20	M6-6H	35	15	M6-6H	
20A(C)6,3X072	6,3	8,69	20,29	250	3500	38,6	78							
20A(C)8,2X072	8,2	11,32	26,40	250	3500	40,6	78							
20A(C)10X072	10	13,95	32,55	250	3500	45	87							
20A(C)11X072	11,3	15,76	36,78	250	3500	45	89,1							
20A(C)12X072	12	16,92	39,48	250	3500	45	90,3							
20A(C)14X072	14	19,95	46,55	250	3500	45	93,4							
20A(C)15X072	15	21,60	36,00	250	2500	45	94,9							
20A(C)16X072	16	23,04	38,40	250	2500	45	96,5							
20A(C)19X072	19	27,36	45,60	200	2500	45	101,5							
20A(C)22X072	22	31,68	42,24	180	2000	52,5	106,5							
20A(C)25X072	25	36,00	48,00	160	2000	57,2	111,4							