

Designation:

- 20A(C)...X219P4 – flange ports with UNC threads;
- 20A(C)...X219P4M – flange ports with Metric threads;
- 20A(C)...X219M – ports with Metric threads;
- 20A(C)...X219G – ports with GAS threads;

V
Variants for ports – M;G
for port sizes see table on pump 20A(C)...X016...

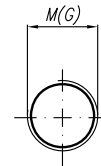

Type		Displacement	Flow		Pressure P _{nom}	max Speed n	Dimension										
			at 1500 rpm	at max rpm			A	B	Inlet				Outlet				
"Caproni"	"Plessey"	cm ³ /rev	l/min	l/min	bar	rpm	mm	mm	E	F	d	d	E	F	d	d	
20A(C)4,5X219...	A(C)10XP4...S	4,5	6,14	14,33	175	3500	42,5	92,8									
20A(C)6,3X219...	A(C)14XP4...S	6,3	8,69	20,29	175	3500	42,5	92,8	30,2	13,1	1/4"-20UNC	M6-6H		13,1			
20A(C)8,2X219...	A(C)18XP4...S	8,2	11,32	26,40	175	3500	42,5	92,8									
20A(C)10X219...	A(C)22XP4...S	10	13,95	32,55	175	3500	47	101,8									
20A(C)11X219...	A(C)25XP4...S	11,3	15,76	36,78	175	3500	48	103,9									
20A(C)12X219...	A(C)26XP4...S	12	16,92	39,48	175	3500	48,6	105,1									
20A(C)14X219...	A(C)31XP4...S	14	19,95	46,55	175	3500	50	108,2									
20A(C)15X219...	A(C)33XP4...S	15	21,60	36,00	175	2500	51	109,7									
20A(C)15X219SS...	A(C)33XP4...SS	15	21,60	36,00	140	2500	48	103,8									
20A(C)16X219...	A(C)35XP4...S	16	23,04	38,40	175	2500	52	111,4									
20A(C)17,3X219...	A(C)38XP4...S	17,3	24,91	41,52	175	2500	52,8	113,4	39,7	19	5/16"-18UNC	M8-6H	30,2	14,2	1/4"-20UNC	M6-6H	
20A(C)19X219...	A(C)42XP4...S	19	27,36	45,60	175	2500	54	116,3									
20A(C)19X219SS...	A(C)42XP4...SS	19	27,36	45,60	105	2500	51,4	110									
20A(C)22X219...	A(C)48XP4...S	22	31,68	42,24	175	2000	57	121,3									
20A(C)25X219...	A(C)55XP4...S	25	36,00	48,00	160	2000	59,2	126,2					39,7	19	5/16	M8	